

Speed Of Road
MPH

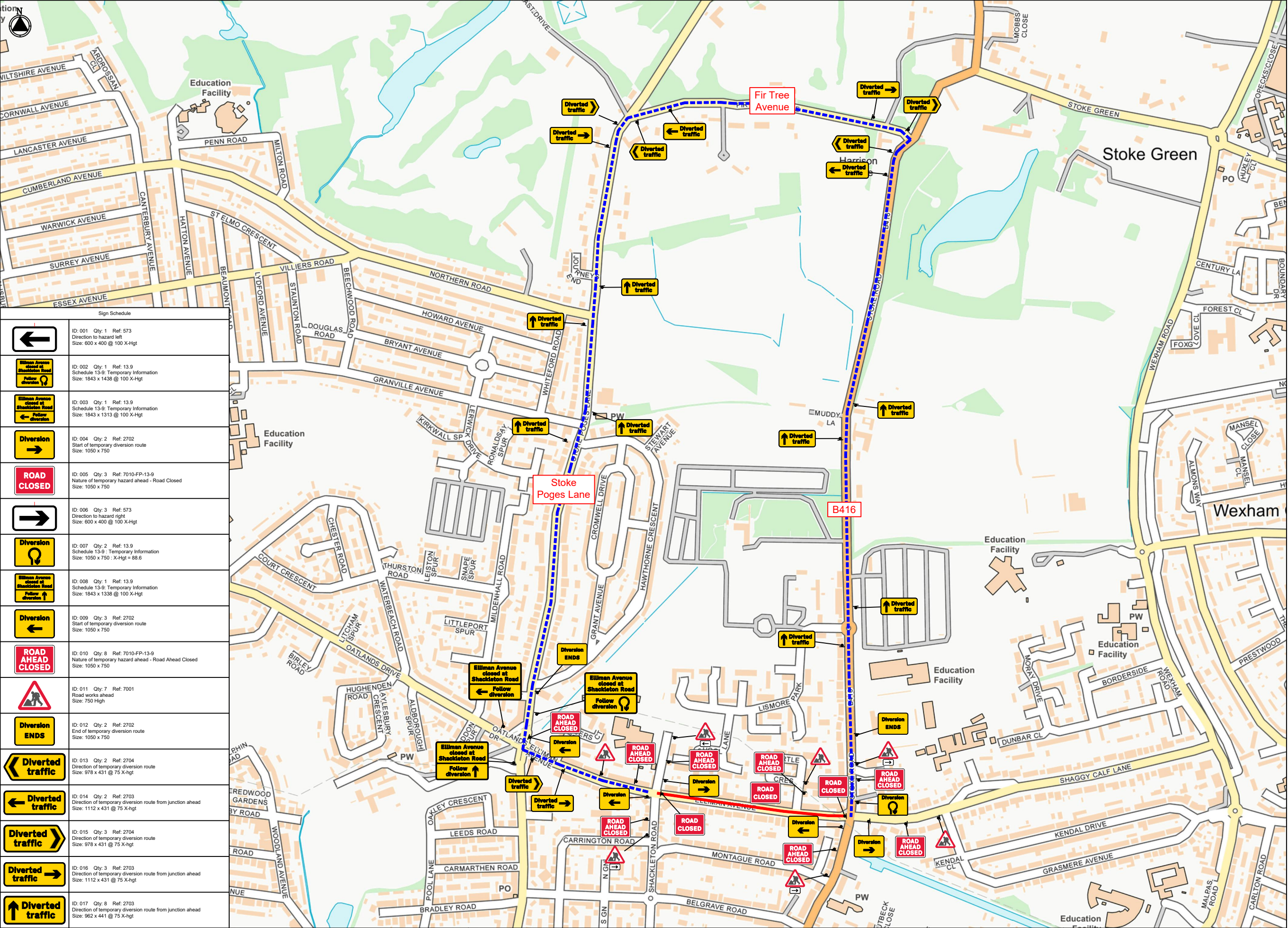

Sign Schedule	
	ID: 001 Qty: 1 Ref: 573 Direction to hazard left Size: 600 x 400 @ 100 X-Hgt
	ID: 002 Qty: 1 Ref: 13.9 Schedule 13-9: Temporary Information Size: 1843 x 1438 @ 100 X-Hgt
	ID: 003 Qty: 1 Ref: 13.9 Schedule 13-9: Temporary Information Size: 1843 x 1313 @ 100 X-Hgt
	ID: 004 Qty: 2 Ref: 2702 Start of temporary diversion route Size: 1050 x 750
	ID: 005 Qty: 3 Ref: 7010-FP-13-9 Nature of temporary hazard ahead - Road Closed Size: 1050 x 750
	ID: 006 Qty: 3 Ref: 573 Direction to hazard right Size: 600 x 400 @ 100 X-Hgt
	ID: 007 Qty: 2 Ref: 13.9 Schedule 13-9: Temporary Information Size: 1050 x 750 : X-Hgt = 88.6
	ID: 008 Qty: 1 Ref: 13.9 Schedule 13-9: Temporary Information Size: 1843 x 1338 @ 100 X-Hgt
	ID: 009 Qty: 3 Ref: 2702 Start of temporary diversion route Size: 1050 x 750
	ID: 010 Qty: 8 Ref: 7010-FP-13-9 Nature of temporary hazard ahead - Road Ahead Closed Size: 1050 x 750
	ID: 011 Qty: 7 Ref: 7001 Road works ahead Size: 750 High
	ID: 012 Qty: 2 Ref: 2702 End of temporary diversion route Size: 1050 x 750
	ID: 013 Qty: 2 Ref: 2704 Direction of temporary diversion route Size: 978 x 431 @ 75 X-hgt
	ID: 014 Qty: 2 Ref: 2703 Direction of temporary diversion route from junction ahead Size: 1112 x 431 @ 75 X-hgt
	ID: 015 Qty: 3 Ref: 2704 Direction of temporary diversion route Size: 978 x 431 @ 75 X-hgt
	ID: 016 Qty: 3 Ref: 2703 Direction of temporary diversion route from junction ahead Size: 1112 x 431 @ 75 X-hgt
	ID: 017 Qty: 8 Ref: 2703 Direction of temporary diversion route from junction ahead Size: 962 x 441 @ 75 X-hgt

Traffic Management

Road Closure

Drawing Notes

Client



All Works Shall Be Carried Out In
Accordance With The Safety At
Streetworks And Code Of Practise
2013

KEY

Sign
Closure Point
Diversion Route

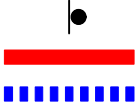

Site Address

Elliman Avenue,
Slough,
SL2 5AZ

Drawing No

PTM/OCUGROUP/TMCD10891/
01 REV 1

Original drawing size A3 - NTS

Drawn By

GB

Date

02.05.2025

