

NOTES:

1. All signs and cones to be in accordance with Chapter 8-2009, the TSRGD and current IAN's.
2. Works access and egress are indicative, exact locations to be agreed on site.
3. Safety zones are to be installed as required.
4. All signs to be located so as not to obscure signs or objects and should be ballasted near to ground level using sand filled hessian bags or sign straps.
5. All sign positions are indicative only and must be accurately positioned on site with good visibility and be clear of and obstructions or vegetation at all times.
6. Drawing not to scale
7. TM will comply with the Safety at Street Works and Road Works Code of Practice

Qty: 1 Ref: 13-9 Schedule 13 : Temporary Sign	
Qty: 1 Ref: 13-9 Schedule 13 : Temporary Sign	
Qty: 1 Ref: 13-9 Schedule 13 : Temporary Sign	
Qty: 3 Ref: 2702 End of temporary diversion route	
Qty: 1 Ref: 2702 Start of temporary diversion route	
Qty: 3 Ref: 2702 Start of temporary diversion route	
Qty: 2 Ref: 2702 Start of temporary diversion route	
Qty: 5 Ref: 2703 Direction of temporary diversion route from junction ahead	
Qty: 2 Ref: 2703 Direction of temporary diversion route from junction ahead	
Qty: 5 Ref: 2704 Direction of temporary diversion route	
Qty: 2 Ref: 2704 Direction of temporary diversion route	
Qty: 1 Ref: 573 Direction to hazard left	
Qty: 1 Ref: 573 Direction to hazard right	
Qty: 1 Ref: 612 No right turn	
Qty: 1 Ref: 613 No left turn	
Qty: 2 Ref: 7001 Road works ahead	
Qty: 1 Ref: 7010-FP-13-9 Nature of temporary hazard ahead - Road Ahead Closed	
Qty: 2 Ref: 7010-FP-13-9 Nature of temporary hazard ahead - Road Closed	
Qty: 2 Ref: 7010.1 Nature of temporary hazard ahead - Road Ahead Closed	

Road Widths:

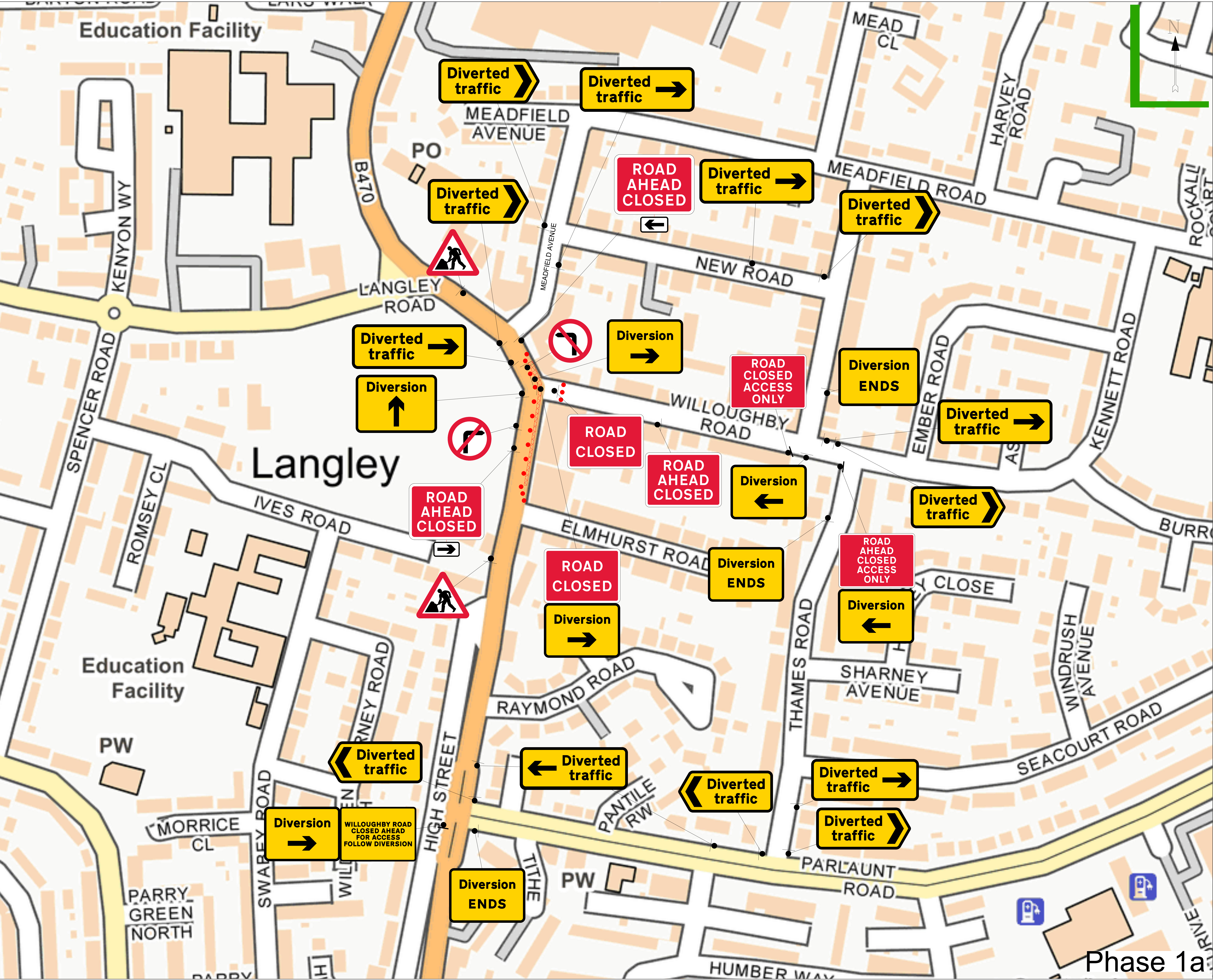

KEY:			
	SAFETY ZONE		CONE
	WORK AREA		PED. BARRIER
	SPOIL AREA		NO PARKING CONE
			Bus Stop Suspension
			Parking Bay Suspension

DETAILS OF THE ROAD
Willoughby Road

Drawn By	K Patel	Traffic Management	Road Closure
Checked By	R Tudoreanu	Road Name	Willoughby Road
Survey By	Client	Borough/Council	Slough
Date Drawn	05/06/2025	Postcode	SL3 8HD
Drawing No	IMGA252089		